

JUNO®

Project: _____

Fixture Type: _____

Location: _____

Contact/Phone: _____

5" IC 600 LUMEN LED DOWNLIGHT NEW CONSTRUCTION

IC20LEDG3 RECESSED HOUSING LENSED TRIMS



PRODUCT DESCRIPTION

Dedicated LED, Air-Loc® sealed new construction housing with integral light engine • Shallow housing allows for fit in 2 x 6 construction • Can be completely covered with insulation • Fully sealed housing stops infiltration and exfiltration of air, reducing heating and air cooling costs without the use of additional gaskets • LED housing is designed to provide 50,000 hours of life and is compatible with many standard Juno trims • 5 year limited warranty on LED components.

ENVIRONMENTALLY FRIENDLY, ENERGY EFFICIENT

- No harmful ultraviolet or infrared wavelengths
- No lead or mercury
- Comparable light output to 65W BR30 incandescent while consuming less than 11W*



PRODUCT SPECIFICATIONS

LED Light Engine LED array integrated to one piece high purity aluminum, thermally conductive housing provides uninterrupted heat transfer to ensure long life of the LED • Replaceable light engine mounts directly to housing and incorporates the latest generation, high lumen output LED array • LEDs are binned to standards that exceed ENERGY STAR® requirements yielding superior fixture to fixture color uniformity • 2700K, 3000K, 3500K, or 4100K color temperatures available • 83 CRI typical.

Optical System Computer-optimized reflector design with high reflectance white finish coupled with a high transmission diffusing lens conceals the LEDs and produces uniform aperture luminance • Wide flood distribution shipped as standard with optional optic accessories available and sold separately.

Aesthetic Trim Selections Compatible with wide selection of existing Juno trims • Shadow free, knife edge design blends seamlessly into ceiling. • Trims are wet location approved for covered applications.

LED Driver Choice of dedicated 120 volt driver or universal voltage driver that accommodates input voltages from 120-277 volts AC at 50/60Hz • Power factor > 0.9 at 120V input • 120 volt only driver is dimmable with the use of most incandescent, magnetic low voltage and electronic low voltage wall box dimmers • Universal voltage driver is dimmable with the use of most 0-10V wall box dimmers • For a list of compatible dimmers, see JUNOLEDG3-DIM • Mounted between the j-box and housing for easy access and cool operation.

Life Rated for 50,000 hours at 70% lumen maintenance.

Labels Certified to the high efficiency requirements of California T24-2008 with select trims • UL listed for U.S and Canada through-branch wiring, wet locations (covered ceilings) • Union made • UL and cUL.

Testing All reports are based on published industry procedures; field performance may differ from laboratory performance.

Product specifications subject to change without notice.

HOUSING FEATURES

Housing Designed for use in IC (insulated ceiling) or non-IC construction • Aluminum housing sealed for Air-Loc® compliance • Housing is vertically adjustable to accommodate up to a 2" ceiling thickness.

Junction Box Pre-wired junction box provided with (5) ½" and (1) ¾" knockouts, (4) knockouts for 12/2 or 14/2 NM cable and ground wire • UL listed and cUL listed for through-branch wiring, maximum 8 #12 branch circuit conductors • Junction box provided with removable access plates • Knockouts equipped with pryout slots • Quick connect electrical connectors supplied as standard for fast, secure installation.

Mounting Frame 22-gauge die-formed galvanized steel mounting frame • Rough-in section (junction box, mounting frame, housing and bar hangers) fully assembled for ease of installation.

Real Nail 3 Bar Hangers Telescoping Real Nail 3® system permits quick placement of housing anywhere within 24" O.C. joists or suspended ceilings • Includes removable nail for repositioning of fixture in wood joist construction • Integral T-bar notch and clip for suspended ceilings • Design covered under Patents US5,505,419 and D552,969.

DIMENSIONS

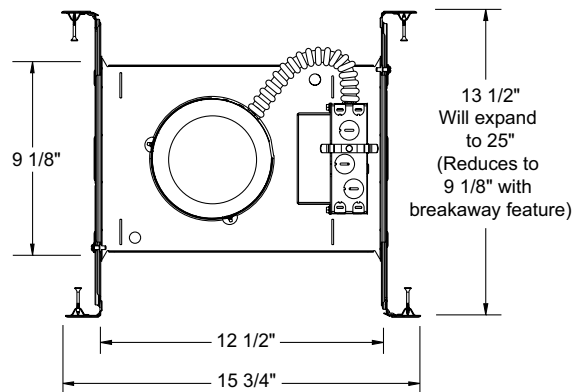
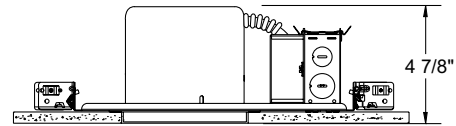

5 5/8" CEILING CUTOUT

ELECTRICAL DATA

Dedicated 120V Only Driver Option

120V	
Input Power	10.5W (+/-5%)
Input Current - Max	0.10A
Frequency	50/60Hz
EMI/RFI	FCC Title 47 CFR, Part 18, Class B (consumer)
Minimum starting temp	-20°C

ELECTRICAL DATA

Universal Voltage

	120V	277V
Input Power	12W (+/-5%)	12.3W (+/-5%)
Input Current - Max	0.11A	0.055A
Frequency	50/60Hz	50/60Hz
EMI/RFI	FCC Title 47 CFR, Part 15, Class A (non-consumer)	FCC Title 47 CFR, Part 15, Class A (non-consumer)
Minimum starting temp	-40°C	-40°C

* Nominal input wattage @ 120-volt operation with dedicated 120-volt driver under stable operating conditions.

5" IC 600 LUMEN LED DOWNLIGHT NEW CONSTRUCTION LENSED TRIMS

ORDERING INFORMATION: Housing, trim and accessories each ordered separately.

Example: **IC20LEDG3-3K-1**

Housing	Color Temperature	Input Voltage
IC20LEDG3	27K 2700K 3K 3000K 35K 3500K 41K 4100K	1 Dedicated 120V Only (Forward Phase + ELV dimmable) U Universal Voltage, 120-277V (0-10V dimmable)





ACCESSORIES

Catalog No.	Description
LEDOPTICG3-M	Medium Flood Optic (50°)
LEDOPTICG3-N	Narrow Flood Optic (37°)
LEDOPTICG3-S	Spot Optic (10°)

To order, specify catalog number.

Example: **2130W-WH**

Trim/Description

-  **210N-WH** *
210N-SC *
210N-ABZ *
Flat Glass Shower Trim
-  **212N-WH** *
212N-SC *
212N-ABZ *
Frosted Lens with Clear Center
-  **2130W-WH** *
2130B-WH *
White Baffle Regressed Frosted Dome Lens with Reflector
Black Baffle Regressed Frosted Dome Lens with Reflector
-  **5101-ABZ** *
5101-SC *
5101-WH *
Beveled Frame - Frosted Dome Lens with Reflector

UL Listed for use in wet location.

¹ 120V: T24 @ 41K only

* Do not use reflector shipped with trim for LED housing.

Trim Size: 210, 212, 2130 - 6¼" O.D.; 5101 - 6½" O.D.

Trim Finish: ABZ - Classic Aged Bronze, SC - Satin Chrome, WH - White

Note: In Canada when insulation is present, Type IC fixtures must be used.

 JUNO IC housings meet IECC Energy Code requirements per ASTM E283.

Air-Loc® rated trims are pre-gasketed for minimum air leakage with IC housings.

PHOTOMETRIC REPORT

Test Report #: PT10112502
 Catalog No: IC20LEDG3-35K
 with 210-WH Trim
 and standard wide flood optic

Luminaire Spacing Criterion: 0.91

Luminaire LPW: 40.5

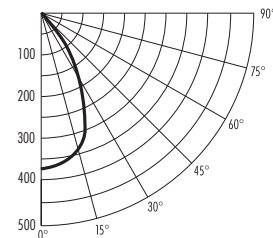

CANDLEPOWER DISTRIBUTION (Candelas)

Degrees	Candelas
Vertical	0°
0	372
5	366
15	327
25	241
35	129
45	63
55	33
65	18
75	9
85	2
90	0

Multiplier: 27K - 0.90
 3K - 0.97
 41K - 1.04

AVERAGE INITIAL FOOTCANDLES

Multiple Units (Square Array, 60"x60' room)
 Ceiling 80% Wall 50% Floor 20%

Spacing	RCR1	RCR3	RCR5
4.0'	29	25	21
5.0'	19	16	14
6.0'	13	11	9
7.0'	11	9	8
8.0'	8	7	6
9.0'	6	5	5
10.0'	5	4	3

ZONAL LUMEN SUMMARY

Zone	Lumens	%Lamp	%Fixture
0-30°	239	29.9	55.7
0-40°	321	40.1	74.7
0-60°	399	49.9	93.0
0-90°	429	53.7	100.0

INITIAL FOOTCANDLES (One Unit, 10.6W, 59.6° Beam)

Distance to Illuminated Plane (Feet)	Footcandles Beam Center	Beam Diameter
4	23.3	4.6'
6	10.3	6.9'
8	5.8	9.2'
10	3.7	11.5'

LUMINANCE (Average cd/m²)

Degrees	Average Luminance
45	7057
55	4556
65	3385
75	2841
85	1914

Fixtures tested to IES recommended standard for solid state lighting per LM-79-08. Photometric performance on a single unit represents a baseline of performance for the fixture. Results may vary in the field.

