



TRAC-MASTER®

Avant Garde

STRAPS LOW VOLTAGE SERIES

T621

Project: _____

Fixture Type: _____

Location: _____

Contact/Phone: _____

PRODUCT DESCRIPTION

This unique semi-exposed lamp design is enhanced by a bold die-cast face plate and die-formed yoke. A 12V Power Pack is required for each Trac light.

Construction Die-formed aluminum with Die-cast aluminum face plates.

Aiming 90° vertical aiming capability and 358° rotation • One locking screw provided.

Transformer **T537** or **T538** 12V solid state electronic transformer with on/off switch • Must be ordered separately • Refer to specification sheet D1.2.1.

Labels UL listed, CSA certified.

Product specifications subject to change without notice.



Low Voltage MR16

Lampholder Ceramic bi-pin.

Catalog Number	Finish	Lamp
T621WH	White	20-75W MR16
T621BL	Black	20-75W MR16
T621SA	Satin Aluminum	20-75W MR16

ACCESSORIES

Cat. No.	Description	Cat. No.	Description	Cat. No.	Description
T74BL	Black Barn Doors	T556BL	Black Eyebrow	T551-5	Color Filters
T557	Prismatic Spread Lens	T559	Linear Spread Lens	T5501-18	Dichroic Lenses
T5520	Diffuse Spread Lens	T5521	Uniformity Lens	T5522	UV Filter Lens
T5559BL	Hexcell Louver				

See specification sheet D1.2.2 for details.

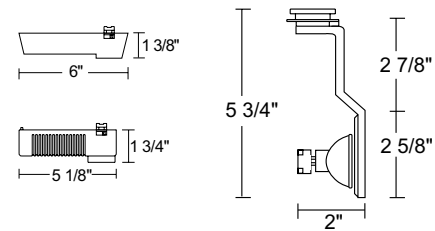

TRAC-MASTER®

Avant Garde

STRAPS LOW VOLTAGE SERIES

T621

CBCP • Centerbeam candlepower
FC • Footcandles at beam center (aim point)

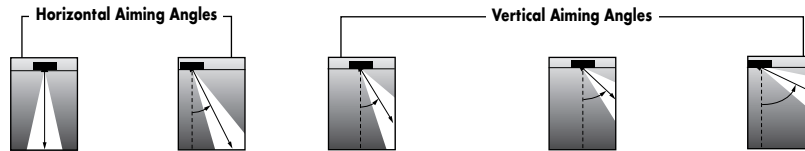

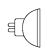
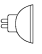
Lamp	Beam Type	Beam Spread°	Rated Life	CBCP	0°		30°			30°			45°				60°								
					MH	FC	L	W	FC	L	W	D	FC	X	L	W	FC	X	L	W	D	FC	X	L	W
	SP	20°	5000	3900	4	244	1.4	1.4	158	1.9	1.6	2	122	3.5	3.1	1.4	345	2.0	1.5	1.0	4	158	2.3	1.9	1.6
					6	108	2.1	2.1	70	2.8	2.4	3	54	5.2	4.7	2.1	153	3.0	2.2	1.5	6	70	3.5	2.8	2.4
					8	61	2.8	2.8	40	3.8	3.3	4	31	6.9	6.2	2.8	86	4.0	2.9	2.0	8	40	4.6	3.8	3.3
					10	39	3.5	3.5	25	4.7	4.1	5	20	8.7	7.8	3.5	55	5.0	3.6	2.5	10	25	5.8	4.7	4.1
					12	27	4.2	4.2	18	5.7	4.9	6	14	10.4	9.3	4.2	38	6.0	4.4	3.0	12	18	6.9	5.7	4.9
					12	27	4.2	4.2	18	5.7	4.9	6	14	10.4	9.3	4.2	38	6.0	4.4	3.0	12	18	6.9	5.7	4.9
	FL	40°	5000	1000	4	63	2.9	2.9	41	4.1	3.4	2	31	3.5	9.6	2.9	88	2.0	3.4	2.1	4	41	2.3	4.1	3.4
					6	28	4.4	4.4	18	6.1	5.0	3	14	5.2	14.5	4.4	39	3.0	5.0	3.1	6	18	3.5	6.1	5.0
					8	16	5.8	5.8	10	8.1	6.7	4	8	6.9	19.3	5.8	22	4.0	6.7	4.1	8	10	4.6	8.1	6.7
					10	10	7.3	7.3	6	10.2	8.4	5	5	8.7	24.1	7.3	14	5.0	8.4	5.1	10	6	5.8	10.2	8.4
					12	7	8.7	8.7	5	12.2	10.1	6	3	10.4	**	8.7	10	6.0	10.1	6.2	12	5	6.9	12.2	10.1
					12	7	8.7	8.7	5	12.2	10.1	6	3	10.4	**	8.7	10	6.0	10.1	6.2	12	5	6.9	12.2	10.1
	NSP	15°	6000	9100	4	638	1.0	1.0	414	1.3	1.1	2	319	3.5	2.1	1.0	902	2.0	1.0	0.7	8	104	4.6	2.6	2.3
					6	283	1.5	1.5	184	2.0	1.7	3	142	5.2	3.1	1.5	401	3.0	1.5	1.0	10	66	5.8	3.3	2.8
					8	159	2.0	2.0	104	2.6	2.3	4	80	6.9	4.1	2.0	225	4.0	2.0	1.4	12	46	6.9	3.9	3.4
					10	102	2.5	2.5	66	3.3	2.8	5	51	8.7	5.1	2.5	144	5.0	2.5	1.7	14	34	8.1	4.6	4.0
					12	71	2.9	2.9	46	3.9	3.4	6	35	10.4	6.2	2.9	100	6.0	3.0	2.1	16	26	9.2	5.3	4.5
					12	71	2.9	2.9	46	3.9	3.4	6	35	10.4	6.2	2.9	100	6.0	3.0	2.1	16	26	9.2	5.3	4.5
	NFL	25°	6000	3200	4	213	1.9	1.9	138	2.6	2.2	2	106	3.5	4.6	1.9	301	2.0	2.0	1.4	4	138	2.3	2.6	2.2
					6	94	2.9	2.9	61	3.9	3.3	3	47	5.2	7.0	2.9	134	3.0	3.1	2.0	6	61	3.5	3.9	3.3
					8	53	3.8	3.8	35	5.2	4.4	4	27	6.9	9.3	3.8	75	4.0	4.1	2.7	8	35	4.6	5.2	4.4
					10	34	4.8	4.8	22	6.5	5.5	5	17	8.7	11.6	4.8	48	5.0	5.1	3.4	10	22	5.8	6.5	5.5
					12	24	5.8	5.8	15	7.8	6.7	6	12	10.4	13.9	5.8	33	6.0	6.1	4.1	12	15	6.9	7.8	6.7
					12	24	5.8	5.8	15	7.8	6.7	6	12	10.4	13.9	5.8	33	6.0	6.1	4.1	12	15	6.9	7.8	6.7
FL	40°	6000	1700	4	116	2.9	2.9	75	4.1	3.4	2	58	3.5	9.6	2.9	164	2.0	3.4	2.1	4	75	2.3	4.1	3.4	
				6	51	4.4	4.4	33	6.1	5.0	3	26	5.2	14.5	4.4	73	3.0	5.0	3.1	6	33	3.5	6.1	5.0	
				8	29	5.8	5.8	19	8.1	6.7	4	14	6.9	19.3	5.8	41	4.0	6.7	4.1	8	19	4.6	8.1	6.7	
				10	19	7.3	7.3	12	10.2	8.4	5	9	8.7	24.1	7.3	26	5.0	8.4	5.1	10	12	5.8	10.2	8.4	
				12	13	8.7	8.7	8	12.2	10.1	6	6	10.4	**	8.7	18	6.0	10.1	6.2	12	8	6.9	12.2	10.1	
				12	13	8.7	8.7	8	12.2	10.1	6	6	10.4	**	8.7	18	6.0	10.1	6.2	12	8	6.9	12.2	10.1	

The beam spread in degrees and the beam "L" and "W" in the following tables are computed at 50% of centerbeam candlepower and represent areas of "effective illumination."

**Due to steep aiming angle, length of beam extends beyond 25'.

For additional Lamp Data, reference Juno Lighting Product Guide.

