

## FEATURES & SPECIFICATIONS

**INTENDED USE** — Lithonia Linear is a suspended linear fixture designed for open, mixed, grid, or hard surface applications. The perfect blend of configurability and simplicity - Lithonia Linear is perfect for contractors, design builders, architects and specifiers for use in almost any application including open ceilings, retail, office, hospitality, education, healthcare, and transportation.

**CONSTRUCTION** — Lithonia Linear is built on an extruded aluminum chassis for the perfect blend of strength, weight, and thermal performance. The power modules/ end caps are made of injections molded plastic and lens is constructed of polycarbonate.

**OPTICS** — Lithonia Linear utilizes a frosted polycarbonate diffuser which provides an optimal 13% uplight to prevent a dark ceiling effect without reducing overall fixture efficiency.

**CONTROLS** — **Integrated Sensor (nLight® Wired Networking):** This sensor is nLight-enabled, meaning it has the ability to communicate over an nLight network. When wired, using CAT-5 cabling, with other nLight-enabled sensors, power packs, or WallPods, an nLight control zone is created. Once linked to a Gateway, directly or via a Bridge, the zone becomes capable of remote status monitoring and control via SensorView software.

**Integrated Smart Sensor (nLight Air Wireless Platform):** The RES7 sensor is nLight AIR enabled, meaning it has the ability to communicate over the wireless nLight control platform. It is available with an automatic dimming photocell, and either a digital PIR or a microphonics (PDT) dual technology occupancy sensor. It pairs to other luminaires and wall switches through our mobile app, CLAIRITY+, which allows for simple sensor adjustment

**Integrated Wireless Sensor (single room control):** Sensor Switch™ VPIR15 or VAPIR15 luminaire-embedded occupancy and ambient light sensor allows the luminaire to power off when the space is unoccupied or when enough ambient light is entering the space.

**INSTALLATION** — Lithonia Linear is designed to be extremely easy to install in multiple applications. Adjustable mounting points and aircraft cable make it easy to order, without knowing exact layouts and mounting points ahead of time. Just by determining if you have an open ceiling or T-grid style ceiling, you can order everything you need for a hassle-free installation. All power cords are factory installed and suspension hardware is included with each luminaire. We have taken the guesswork out of what you need for the installation.

**LISTINGS** — UL certified to US and Canadian safety standards. Damp location listed. IP5X Option. DesignLights Consortium® (DLC) qualified product. Not all versions of this product may be DLC qualified. Please check the DLC Qualified Products List at [www.designlights.org/QPL](http://www.designlights.org/QPL) to confirm which versions are qualified.

**WARRANTY** — 5-year limited warranty. This is the only warranty provided and no other statements in this specification sheet create any warranty of any kind. All other express and implied warranties are disclaimed. Complete warranty terms located at: [www.acuitybrands.com/support/warranty/terms-and-conditions](http://www.acuitybrands.com/support/warranty/terms-and-conditions)

**Note:** Actual performance may differ as a result of end-user environment and application. All values are design or typical values, measured under laboratory conditions at 25 °C. Specifications subject to change without notice.

**MOUNTING HARDWARE** — Mounting hardware included and optional replacement parts table on page 3.

|                |
|----------------|
| Catalog Number |
| Notes          |
| Type           |

### Open Ceiling LED Suspended

# LL

Lithonia® Linear



EPD ZT DEC



EPD EZTR DEC



EPD EZCB DEC



### ORDERING INFORMATION

Lead times will vary depending on options selected. Consult with your sales representative.

**Example:** LL8 6000LM 80CRI CPD MIN10 ZT MVOLT F1/120A DNA

| Series                   | Lumens ‡             | CRI   | CCT       | Power Drop (See images below on page 6) | Minimum Dimming Level | Dimming                              |
|--------------------------|----------------------|-------|-----------|---|-----------------------|--------------------------------------|
| LL4 4' LED Suspended     | 3000LM 3000 Lumens   | 80CRI | 30K 3000K | CPD Center Power Drop ‡                 | MIN1 Dims to 1% ‡     | ZT Generic 0-10V integrated driver ‡ |
|                          | 4000LM 4000 Lumens   |       | 35K 3500K | EPD End Power Drop ‡                    | MIN10 Dims to 10%     | <u>Remote driver box</u>             |
|                          | 5000LM 5000 Lumens   |       | 40K 4000K |   |                       | ZTR Generic 0-10V driver ‡           |
| LL8 8' LED Suspended     | 6000LM 6000 lumens   |       | 50K 5000K |   |                       | SLD Step level dimming ‡             |
|                          | 8000LM 8000 lumens   |       |           |   |                       | EZTR eldoLED 0-10V remote box        |
|                          | 10000LM 10000 lumens |       |           |   |                       | EZCR eldoled controls remote box ‡   |
| LL16 16' LED Suspended ‡ | 12000LM 12000 lumens |       |           |   |                       | <u>Driver backpack</u>               |
|                          | 16000LM 16000 lumens |       |           |   |                       | EZTB eldoLED 0-10V backpack ‡        |
|                          | 20000LM 20000 lumens |       |           |   |                       | EZCB eldoled controls backpack ‡     |

| Voltage                              | Emergency Option   | Mounting Type/Overall Suspension ‡ (See images below on page 3)  | Finish ‡  |
|--------------------------------------|--|--|---|
| MVOLT MVOLT (120-277V)<br>347 347V ‡ | (Blank) no emergency option<br>IE10WCP 10W Emergency backup ‡<br>IE10WCPHE 10W Emergency backup w/standby mode (T20) ‡<br>IE7WCPHE 7W Emergency back w/standby mode (T20) ‡<br>GTD Generator Transfer Device ‡ | F1/120A T-bar ceiling (universal mounting bracket) 120" (10ft) Adjustable Aircraft Cables, 18/5 SJT, Cord Included. Canopy included.<br>F1/240A T-bar ceiling (universal mounting bracket) 240" (20ft) Adjustable Aircraft Cables, 18/5 SJT, Cord Included. Canopy included.<br>F2/120A Hard Ceiling (horizontal J-box) 120" (10ft) Adjustable Aircraft Cables, 18/5 SJT, Cord Included. Canopy included.<br>F2/240A Hard ceiling (horizontal J-box) 240" (20ft) Adjustable Aircraft Cables, 18/5 SJT, Cord Included. Canopy included.<br>F3/120A Open Ceiling (closed loop) 120" (10ft) Adjustable Aircraft Cables, 18/5 SJT, Cord Included. Canopy not included.<br>F3/240A Open Ceiling (closed loop) 240" (20ft) Adjustable Aircraft Cables, 18/5 SJT, Cord Included. Canopy not included. | WH Matte White, fixture finish and cord set<br>DNA Natural Aluminum, fixture finish and white cord set<br>MB Matte Black, fixture finish and cord set |

NOTE: ‡ Indicates option chosen has ordering restrictions or note. Please reference ordering notes chart. Options are sorted alphanumerically.

# LL LED Suspended

| Controls   |   |
|--|---|
| <b>Control Input</b><br>(blank) No Control Input   | <b>Sensor</b><br>(blank) No Sensor or Control Input function only, if selected.   |
| NLTAIR2 nLight AIR Generation 2 (wireless) enabled ‡<br>NLTAIREM2 nLight AIR Generation 2 (wireless) enabled and UL924 Emergency Operation, via power interrupt detection ‡  | (blank) No sensor, Control Input function only<br>APIR Occ sensing with passive infrared - on/off functionality and auto dimming photocell<br>APDT Occ sensor dual tech (passive infrared & microphonics) and auto dimming photocell<br>APIREM Occ sensing with passive infrared - on/off functionality and auto dimming photocell and UL924 Emergency Operation, via power interrupt detection<br>APDTEM Occ sensor dual tech (passive infrared & microphonics) and auto dimming photocell and UL924 Emergency Operation, via power interrupt detection. |
| NLIGHT nLight enabled<br>NLIGHTER nLight enabled, for use with generator supply EM power<br>NLIGHTLM nLight enabled with lumen management<br>NLIGHTERLM nLight enabled with lumen management, for use with generator supply EM power | (blank) No sensor, Control Input function only<br>PIR Occ sensing with passive infrared - on/off functionality<br>PDT Occ sensor dual tech (passive infrared & microphonics)<br>APIR Occ sensing with passive infrared - on/off functionality and auto dimming photocell<br>APDT Occ sensor dual tech (passive infrared & microphonics) and auto dimming photocell<br>VPIR15 Vertex low-profile on/off occupancy PIR occupancy sensor at 15ft mounting height   |
| SSE Sensor Switch Embedded   | APIR Occ sensing with passive infrared - on/off functionality and auto dimming photocell<br>APDT Occ sensor dual tech (passive infrared & microphonics) and auto dimming photocell<br>VPIR15 Vertex low-profile on/off occupancy PIR occupancy sensor at 15ft mounting height<br>VAPIR15 Vertex low-profile on/off occupancy sensor with auto dimming photocell at 15ft mounting height   |
| JOT JOT, "Just One Touch" (wireless) enabled   | (blank) No sensor, Control Input function only<br>VAPIR15 Vertex low-profile on/off occupancy sensor with auto dimming photocell at 15ft mounting height  |
| End Cap Options<br>(When ordering EPD. See page 6 with configuration examples. Aesthetic pieces only)  |   |
| (Blank) Center Power Drop<br>DEC Decorative End Cap<br>DEM Decorative End Module   | <b>Options</b><br>IP5X Gasketing to meet IP5X rating ‡<br>NLG No Lithonia Logo  |

NOTE: ‡ Indicates option chosen has ordering restrictions or note. Please reference ordering notes chart. Options are sorted alphanumerically.

| ‡ Ordering Notes/ Restrictions         |  |
|--|--|
| Option value                           | Restriction  |
| LL16                                   | LL16 EPD ordered with controls must be EZCR. LL16 CPD ordered with NLTAIR, SSE/JOT can be ordered with EZCB and EZCR. If ordering NLIGHT, NLIGHTER, NLIGHTLM, NLIGHTERLM must be SLD or EZCR.      |
| Lumens                                 | Nominal lumen output.  |
| CPD, EPD                               | CPD comes with (DEC) decorative end caps. CPD is not available in LL4. EPD ships with choice of decorative end caps (DEC) or decorative module (DEM). LL16 EPD ships with decorative module (DEM). |
| MIN1                                   | Only available with nLight, nLight Air and EldoLED.  |
| ZT                                     | Not available with MIN1, Controls or EM, 347V.   |
| ZTR                                    | Generic driver available with with 347V, EM or GTD. Not available with MIN1 and controls   |
| SLD                                    | Only available with remote box driver. Not available with controls, 347V or MIN1.  |
| EZCR                                   | When ordering EZCR luminaire, two cords will run from the remote driver box to the power module on the fixture.  |
| EZTB, EZCB                             | Not available with EM or 347V.   |
| 347                                    | Must be remote driver box mounted. Not available with Emergency, GTD or ZT, EZTB, EZCB.  |
| IE10WCP, IE10WCPHE, IE7WCPHE GTD       | Not available with 347. Must be remote mounted – EZTR, EZCR, ZTR. Not available with ZT.   |
| Mounting Type/ Overall Suspension      | All mounting/suspension cable and hardware included. Refer to the Mounting/Suspension Hardware Included Key on page 3 for the number of suspension drops and power feed(s).                        |
| Finish                                 | Metal components painted after fabrication.  |
| NLTAIR2                                | Can be used as a normal power sensing device for nLight AIR devices and luminaires with EM emergency options.  |
| NLTAIREM2                              | See UL924 Sequence of Operation. Leave Sensor option group blank, not available with APIR, APDT, APIREM and APDTEM.  |
| NLIGHT, NLIGHTER, NLIGHTLM, NLIGHTLMER | Must be remote box mounted EZCR.   |
| JOT                                    | Only available with EZCR and EZCB.   |
| IP5X                                   | Gasketing for the driver enclosure to meet IP5X. Only available with ZT.   |

# LL LED Suspended

## WHAT'S IN THE BOX:



## + MOUNTING/ HARDWARE BAG

| F1 – T-GRID ceiling mount |                                |
|---------------------------|--------------------------------|
| LL4 EPD                   | 1ZAC + 1ZACFP + 2 T GRID CLIPS |
| LL8 CPD                   | 2ZAC + 1ZACFP + 3 T GRID CLIPS |
| LL8 EPD                   | 1ZAC + 1ZACFP + 2 T GRID CLIPS |
| LL16 CPD                  | 2ZAC + 1ZACFP + 3 T GRID CLIPS |
| LL16 EPD                  | 2ZAC + 2ZACFP + 4 T GRID CLIPS |

| F2 – Hard ceiling mount |               |
|-------------------------|---------------|
| LL4 EPD                 | 1ZAC + 1ZACFP |
| LL8 CPD                 | 2ZAC + 1ZACFP |
| LL8 EPD                 | 1ZAC + 1ZACFP |
| LL16 CPD                | 2ZAC + 1ZACFP |
| LL16 EPD                | 2ZAC + 2ZACFP |

| F3 – Open ceiling mount |             |
|-------------------------|-------------|
| LL4 EPD                 | 2LLAC + 1PC |
| LL8 CPD                 | 3LLAC + 1PC |
| LL8 EPD                 | 2LLAC + 1PC |
| LL16 CPD                | 3LLAC + 1PC |
| LL16 EPD                | 4LLAC + 2PC |

### POWER CORD (PC)

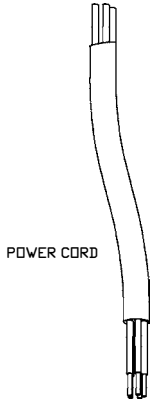

### LLAC

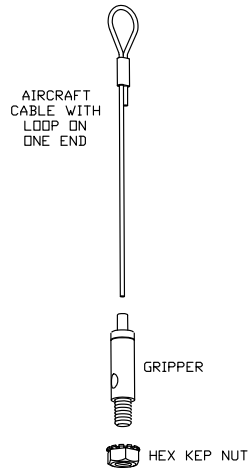

### ZAC

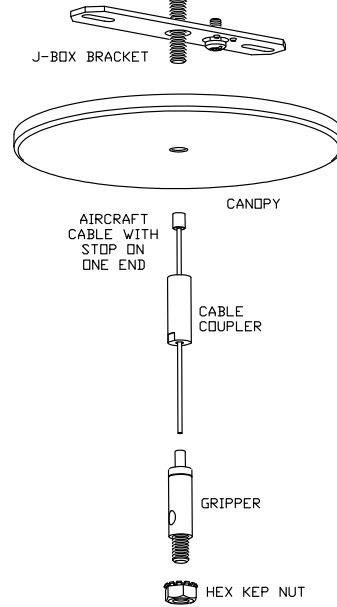

### ZACFP

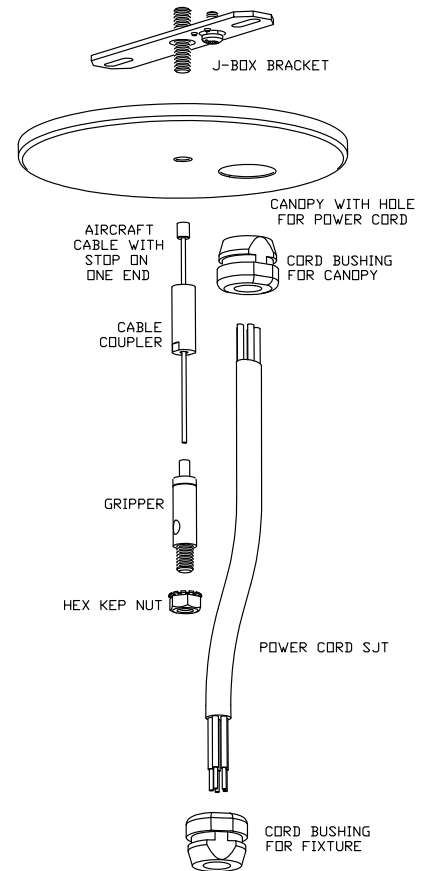

## HARDWARE IMAGES

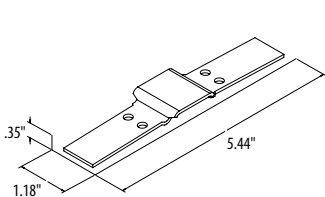

**Joiner Bracket LLCR**

**Note:** \*Included with every fixture configurations

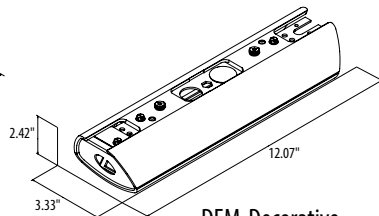

**DEM-Decorative End Module**

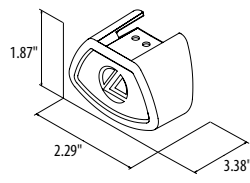

**DEC-Decorative End Cap**

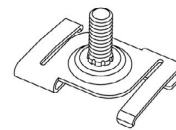

**U0776 (Tgrid Clip)**

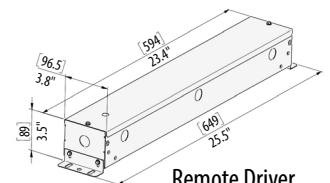

**Remote Driver Box/Emergency Battery Box**

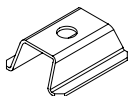

**Sliding Mounting Hardware**

**Note:** \*Included with every fixture configurations



**Screws for power Module Connection**

**Note:** \*Included with every fixture configurations

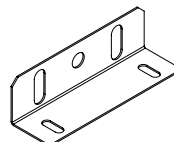

**Remote Box Bracket**

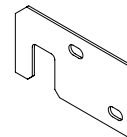

**Remote Box Hanger Bracket**

## Intelligent Luminaire Technology Guide

|                                 |  | Choose nomenclature from these columns |           |        |   |  |  |                             |  |
|---------------------------------|--|--|-----------|--------|---|--|--|-----------------------------|--|
|                                 |  | Control Input                          | Sensor    | Sensor |   | Notes  |  | Previous Nomenclature       |  |
| Control / Sensor Configurations |  | SSE                                    | + APIR    | =      | MSD 7 ADCX                                | Individual fixture control only. PIR integral occupancy sensor with automatic dimming control photocell.                                       |  | MSD7ADCX                    |  |
|                                 |  | SSE                                    | + APDT    | =      | MSD PDT 7 ADCX                            | Individual fixture control only. PDT integral occupancy sensor with automatic dimming control photocell.                                       |  | MSDPDT7ADCX                 |  |
|                                 |  | SSE                                    | + VPIR15  | =      | VERTEX 15F EZ OCC VLP                     | Vertex low-profile on/off occupancy PIR occupancy sensor with VLP programming at 15ft mounting height.   |  | VTX15FOCC                   |  |
|                                 |  | SSE                                    | + VAPIR15 | =      | VERTEX 15F EZ ADC VLP                     | Vertex low-profile on/off occupancy sensor with auto dimming photocell with VLP programming at 15ft mounting height.                           |  | VTX15FADC                   |  |
|                                 |  | JOT                                    | + (blank) | =      | BTRM JOT BTA                              | Wireless room control with "Just One Touch" pairing.   |  | JOT                         |  |
|                                 |  | JOT                                    | + VAPIR15 | =      | BTRM JOT BTA + VERTEX 15F EZ ADC VLP GSMT | Wireless room control with "Just One Touch" pairing.   |  | JOTVTX15                    |  |
|                                 |  | NLIGHT                                 | + (blank) | =      | nIO EZ PH                                 | nLight enabled only. No onboard sensor.  |  | NLIGHT                      |  |
|                                 |  | NLIGHT                                 | + PIR     | =      | nIO EZ PH + nES 7                         | nLight enabled with PIR integral occupancy sensor.   |  | NLIGHT NES7                 |  |
|                                 |  | NLIGHT                                 | + PDT     | =      | nIO EZ PH + nES PDT 7                     | nLight enabled with dual technology occupancy control sensor.  |  | NLIGHT NESPDT7              |  |
|                                 |  | NLIGHT                                 | + APIR    | =      | nIO EZ PH + nES 7 ADCX                    | nLight enabled with PIR integral occupancy sensor with automatic dimming photocell.  |  | NLIGHT NES7ADCX             |  |
|                                 |  | NLIGHT                                 | + APDT    | =      | nIO EZ PH + nES PDT 7 ADCX                | nLight enabled with dual technology occupancy controls sensor with automatic dimming photocell.  |  | NLIGHT NESPDT7ADCX          |  |
|                                 |  | NLIGHT                                 | + VPIR15  | =      | nIO EZ PH + VERTEX 16FT EZ OCC VLP        | nLight enabled with Vertex low-profile on/off occupancy PIR occupancy sensor at 16ft mounting height.  |  | NLIGHT NVTX16FOCC           |  |
|                                 |  | NLIGHTER                               | + (blank) | =      | nIO EZ PH ER                              | Emergency nLight enabled only. No onboard sensor.  |  | NLIGHT EMG                  |  |
|                                 |  | NLIGHTER                               | + PIR     | =      | nIO EZ PH ER + nES 7                      | Emergency nLight enabled with PIR integral occupancy sensor.   |  | NLIGHT EMG NESPDT7          |  |
|                                 |  | NLIGHTER                               | + PDT     | =      | nIO EZ PH ER + nES PDT 7                  | Emergency nLight enabled with dual technology occupancy control sensor.  |  | NLIGHT EMG NES7ADC          |  |
|                                 |  | NLIGHTER                               | + APIR    | =      | nIO EZ PH ER + nES 7 ADCX                 | Emergency nLight enabled with PIR integral occupancy sensor with automatic dimming photocell.  |  | NLIGHT EMG NES7ADCX         |  |
|                                 |  | NLIGHTER                               | + APDT    | =      | nIO EZ PH ER + nES PDT 7 ADCX             | Emergency nLight enabled with dual technology occupancy controls sensor with automatic dimming photocell.                                      |  | NLIGHT EMG NESPDT7ADCX      |  |
|                                 |  | NLIGHTER                               | + VPIR15  | =      | VERTEX 15F EZ OCC VLP                     | Emergency nLight enabled with Vertex low-profile on/off occupancy PIR occupancy sensor at 15ft mounting height.                                |  | NLIGHT NVTX15FOCC           |  |
|                                 |  | NLIGHTLM                               | + (blank) | =      | nIO EZ PH N80                             | nLight enabled only with 80% constant lumen management. No onboard sensor.   |  | NLIGHT CL80                 |  |
|                                 |  | NLIGHTLM                               | + PIR     | =      | nIO EZ PH N80 + nES 7                     | nLight enabled with 80% constant lumen management with PIR integral occupancy sensor.  |  | NLIGHT CL80 NES7            |  |
|                                 |  | NLIGHTLM                               | + PDT     | =      | nIO EZ PH N80 + nES PDT 7                 | nLight enabled with 80% constant lumen management with dual technology occupancy control sensor.   |  | NLIGHT CL80 NESPDT7         |  |
|                                 |  | NLIGHTLM                               | + APIR    | =      | nIO EZ PH N80 + nES 7 ADCX                | nLight enabled with 80% constant lumen management with PIR integral occupancy sensor with automatic dimming photocell.                         |  | NLIGHT CL80 NES7ADCX        |  |
|                                 |  | NLIGHTLM                               | + APDT    | =      | nIO EZ PH N80 + nES PDT 7 ADCX            | nLight enabled with 80% constant lumen management with dual technology occupancy controls sensor with automatic dimming photocell.             |  | NLIGHT CL80 NESPDT7ADCX     |  |
|                                 |  | NLIGHTLM                               | + VPIR15  | =      | nIO EZ PH N80 + VERTEX 8F EZ OCC VLP      | nLight enabled with 80% constant lumen management with Vertex low-profile on/off occupancy PIR occupancy sensor at 16ft mounting height        |  | NLIGHT CL80 NVTX16FOCC      |  |
|                                 |  | NLIGHTLMER                             | + (blank) | =      | nIO EZ PH ER N80                          | Emergency nLight enabled only with 80% constant lumen management. No onboard sensor.   |  | NLIGHT EMG CL80             |  |
|                                 |  | NLIGHTLMER                             | + PIR     | =      | nIO EZ PH ER N80 + nES 7                  | Emergency nLight enabled with 80% constant lumen management with PIR integral occupancy sensor.  |  | NLIGHT EMG CL80 NES7        |  |
|                                 |  | NLIGHTLMER                             | + PDT     | =      | nIO EZ PH ER N80 + nES PDT 7              | Emergency nLight enabled with 80% constant lumen management with dual technology occupancy control sensor.                                     |  | NLIGHT EMG CL80 NESPDT7     |  |
|                                 |  | NLIGHTLMER                             | + APIR    | =      | nIO EZ PH ER N80 + nES 7 ADCX             | Emergency nLight enabled with 80% constant lumen management with PIR integral occupancy sensor with automatic dimming photocell.               |  | NLIGHT EMG CL80 NES7ADCX    |  |
|                                 |  | NLIGHTLMER                             | + APDT    | =      | nIO EZ PH ER N80 + nES PDT 7 ADCX         | Emergency nLight enabled with 80% constant lumen management with dual technology occupancy controls sensor with automatic dimming photocell.   |  | NLIGHT EMG CL80 NESPDT7ADCX |  |
|                                 |  | NLIGHTLMER                             | + VPIR15  | =      | VERTEX 15F EZ OCC VLP                     | Emergency nLight enabled with 80% constant lumen management. Vertex low-profile on/off occupancy PIR occupancy sensor at 15ft mounting height. |  | NLIGHT EMG CL80 NVTX15FOCC  |  |
|                                 |  | NLTAIR2                                | + (blank) | =      | RIO EZ PH 90D G2                          | nLight AIR Generation 2 enabled.   |  | NLTAIR2 RIO                 |  |
|                                 |  | NLTAIR2                                | + (blank) | =      | RIO EZ PH ER 90D G2                       | nLight AIR Generation 2 enabled  |  | NLTAIR2 RIOEM               |  |
|                                 |  | NLTAIR2                                | + APIR    | =      | RES7 G2                                   | nLight AIR Generation 2 enabled.   |  | NLTAIR2 RES7                |  |
|                                 |  | NLTAIR2                                | + APDT    | =      | RES7 PDT 180D G2                          | nLight AIR Generation 2 enabled.   |  | NLTAIR2 RES7PDT             |  |
|                                 |  | NLTAIR2                                | + APIREM  | =      | RES7 EM 180D G2                           | nLight AIR Generation 2 enabled.   |  | NLTAIR2 RES7EM              |  |
|                                 |  | NLTAIR2                                | + APDTEM  | =      | RES7 PDT EM 180D G2                       | nLight AIR Generation 2 enabled.   |  | NLTAIR2 RES7PDTEM           |  |

# LL LED Suspended

| OPTIONAL REPLACEMENT PARTS |         |              |  |
|----------------------------|---------|--------------|--|
|                            | CI Code | Model        | Description  |
| SUSPENSION KIT             | *265WLF | LLAC120      | 120" cable gripper w/nut - NO Canopy   |
|                            | *265WLG | LLAC240      | 240" cable gripper w/nut - NO Canopy   |
|                            | *267MEP | LLCNPY WHT   | White, 5" Canopy with 15/32" and 1/2" diameter holes                                     |
|                            | *267MF2 | LLCNPY BLK   | Black, 5" Canopy with 15/32" and 1/2" diameter holes                                     |
|                            | *211C82 | ZAC120       | 120" cable gripper w/nut - INCL 5" MATTE WHITE CANOPY & BRACKET                          |
|                            | *250E2S | ZAC120 MB    | 120" cable gripper w/nut - INCL 5" MATTE BLACK CANOPY & BRACKET                          |
|                            | *217YRX | ZAC240       | 240" cable gripper w/nut - INCL 5" MATTE WHITE CANOPY & BRACKET                          |
|                            | *2512MC | ZAC240 MB    | 240" cable gripper w/nut - INCL 5" MATTE BLACK CANOPY & BRACKET                          |
|                            | *233RV9 | ZACFPD120    | 5-conductor power feed & 120" cable gripper w/nut - INCL 5" MATTE WHITE CANOPY & BRACKET |
|                            | *250E7S | ZACFPD120 MB | 5-conductor power feed & 120" cable gripper w/nut - INCL 5" MATTE BLACK CANOPY & BRACKET |
|                            | *233RVA | ZACFPD240    | 5-conductor power feed & 240" cable gripper w/nut - INCL 5" WHITE CANOPY & BRACKET       |
|                            | *2512MJ | ZACFPD240 MB | 5-conductor power feed & 240" cable gripper w/nut - INCL 5" MATTE BLACK CANOPY & BRACKET |
| DEM- DECORATIVE END MODULE | *266EU4 | LLCR WH DEM  | Decorative end module, Matte White   |
|                            | *266EUK | LLCR MB DEM  | Decorative end module, Matte Black   |
|                            | *266EUG | LLCR DNA DEM | Decorative end module, Natural Aluminum  |
| DEC- DECORATIVE END CAP    | *286VVV | LLCR WH DEC  | Decorative end cap, Matte White  |
|                            | *286VVX | LLCR DNA DEC | Decorative end cap, Natural Aluminum   |
|                            | *286VVY | LLCR MB DEC  | Decorative end cap, Matte Black  |
| MISCELLANEOUS              | *27253J | RK3LLCR      | Joiner, Galvanized Steel (comes std w/fixture)   |
|                            | *212NF3 | U0776        | Clip used to convert aircraft mounting from JBOX to T-Grid                               |

## DIMENSIONS:

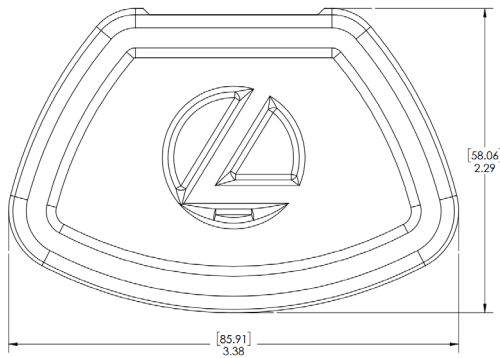

## PERFORMANCE DATA

| Nomenclature                 | Lumens | Wattage | LPW |
|------------------------------|--------|---------|-----|
| LL4 3000LM 80CRI 40K MVOLT   | 3000   | 26      | 117 |
| LL4 4000LM 80CRI 40K MVOLT   | 4045   | 33      | 123 |
| LL4 5000LM 80CRI 40K MVOLT   | 4955   | 41      | 120 |
| LL8 6000LM 80CRI 40K MVOLT   | 6111   | 50      | 121 |
| LL8 8000LM 80CRI 40K MVOLT   | 8327   | 66      | 127 |
| LL8 10000LM 80CRI 40K MVOLT  | 9786   | 79      | 124 |
| LL16 12000LM 80CRI 40K MVOLT | 12223  | 101     | 121 |
| LL16 16000LM 80CRI 40K MVOLT | 16655  | 131     | 127 |
| LL16 20000LM 80CRI 40K MVOLT | 19572  | 158     | 124 |

For 30K - Factor in 5% lumen reduction  
 For 35K - Factor in 3% lumen reduction  
 For 50K - Factor in 2% lumen increase  
 For 347V - Factor in 12% wattage increase  
 Refer to LL4 data upload

| Projected LED Life | L90 | L80 | L70  |
|--------------------|-----|-----|------|
| Hours              | 44K | 92K | 150K |

Values are projections based on TM-21 and at 25C Ambient.

## PALLET DIMENSIONS

| Length/configuration | Fixtures per pallet | Pallet Dims (L X W) |
|----------------------|---------------------|---------------------|
| 4ft                  | 84                  | 50X51               |
| 8ft CPD              | 42                  | 51X51               |
| 8ft EPD              | 56                  | 50X102              |
| 16ft CPD, EPD        | 56                  | 50X102              |

## FIXTURE WEIGHTS

| Length | Weight |
|--------|--------|
| 4ft    | 6lbs   |
| 8ft    | 8lbs   |
| 16ft   | 12lbs  |

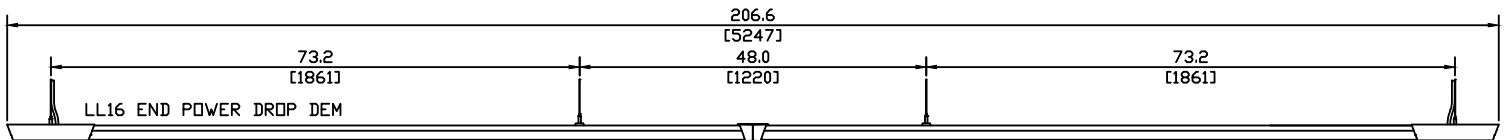
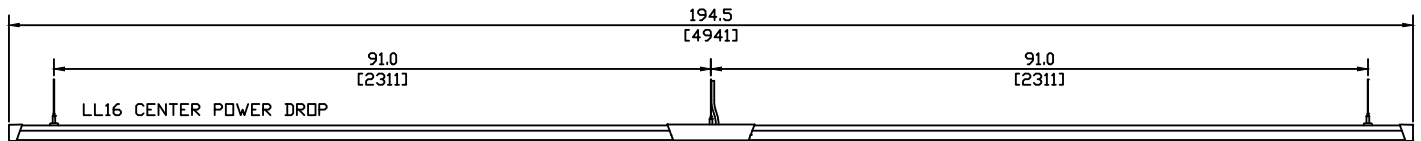
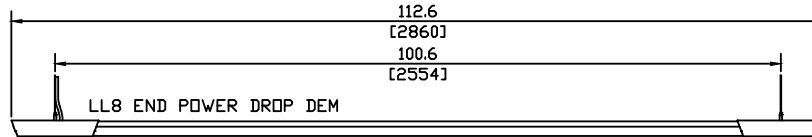
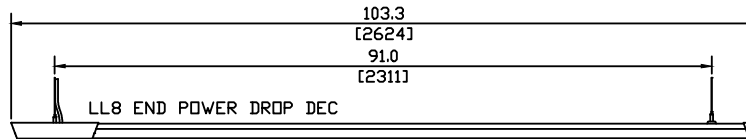
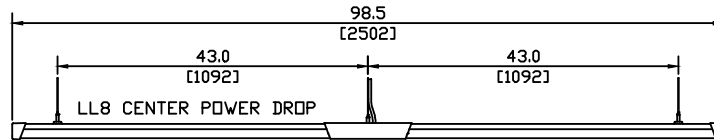
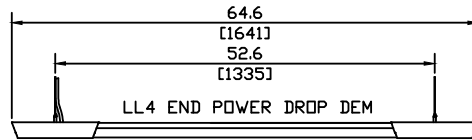
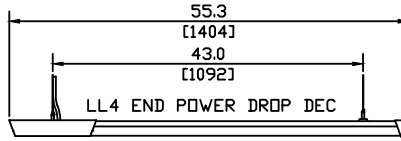

## CONFIGURATIONS:

